

## Filter / Strainers

## Bill of Materials

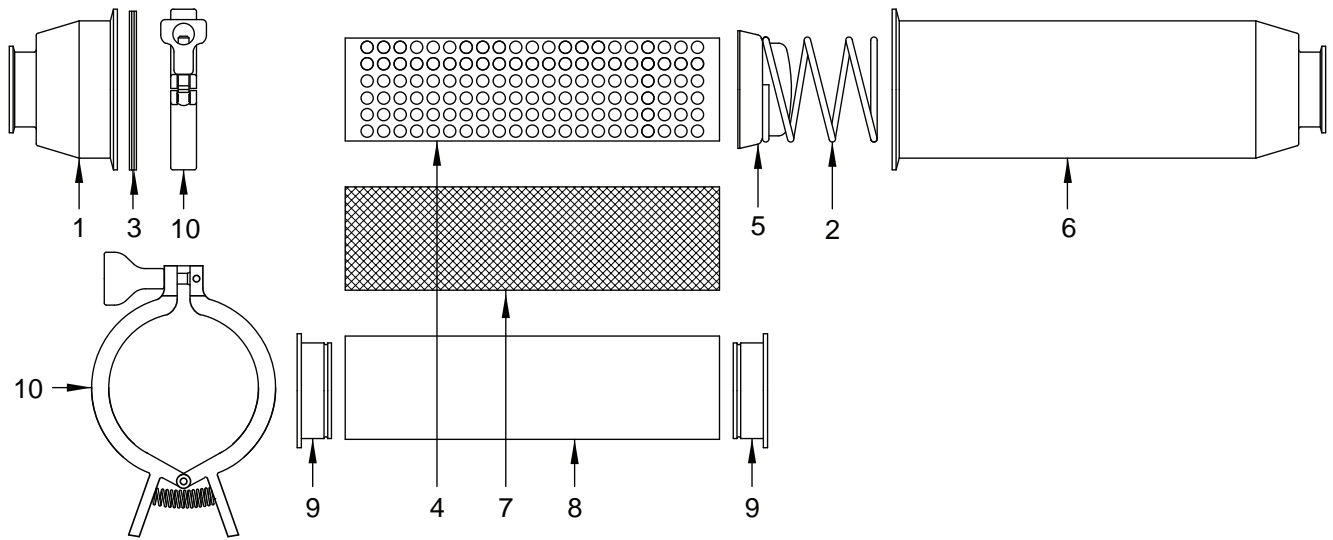

Item #	Description	Short Part #	Long Part #	Material	Qty
1	1" strainer outlet	<b>BS-01-R100</b>	---	316L stainless steel	1
	1½" strainer outlet		<b>BS-01-R150</b>		
	2" strainer outlet		<b>BS-01-R200</b>		
	2½" strainer outlet	<b>BS-01-R250</b>	---		
	3" strainer outlet		<b>BS-01-R300</b>		
2	1" - 2" strainer spring		<b>BS-02-R100-200</b>	316L stainless steel	1
	2½" - 3" strainer spring		<b>BS-02-R250-300</b>		
3	1" - 2" (4") clamp gasket		<b>40MP-U400</b>	Buna	1
	2½" - 3" (4") schedule 5 clamp gasket		<b>40MPV-U400</b>		
4	1" - 2" back-up tube with 1/8" perforations	<b>BS-1418-R100200</b>	<b>BS-2418-R100200</b>	316L stainless steel	1
	2½" - 3" back-up tube with 1/8" perforations	<b>BS-1418-R250300</b>	<b>BS-2418-R250300</b>		
	1" - 2" back-up tube with 1/4" perforations	<b>BS-1425-R100200</b>	<b>BS-2425-R100200</b>		
	2½" - 3" back-up tube with 1/4" perforations	<b>BS-1425-R250300</b>	<b>BS-2425-R250300</b>		
5	1" - 2" strainer cap		<b>BS-05-R100-200</b>	316L stainless steel	1
	2½" - 3" strainer cap		<b>BS-05-R250-300</b>		
6	1" strainer inlet	<b>BS-16-R100</b>	---	316L stainless steel	1
	1½" strainer inlet	<b>BS-16-R150</b>	<b>BS-26-R150</b>		
	2" strainer inlet	<b>BS-16-R200</b>	<b>BS-26-R200</b>		
	2½" strainer inlet	<b>BS-16-R250</b>	---		
	3" strainer inlet	<b>BS-16-R300</b>	<b>BS-26-R300</b>		
7	1" - 3" various mesh over screens (short/long)	part number on page 498		316 stainless steel	1
8	1" - 3" various filter bag (short/long)	part number on page 498		various	1
9	1" - 2" retaining ring used with filter bags		<b>BS-09-U100-200</b>	Buna	2
	2½" - 3" retaining ring used with filter bags		<b>BS-09-U250-300</b>		
10	1" - 2" (4") squeeze clamp		<b>13MHHM-Q400</b>	304 stainless steel	1
	2½" - 3" (4") schedule 5 squeeze clamp		<b>13MHHV-Q400</b>		