

## Filter / Strainers

## Bill of Materials

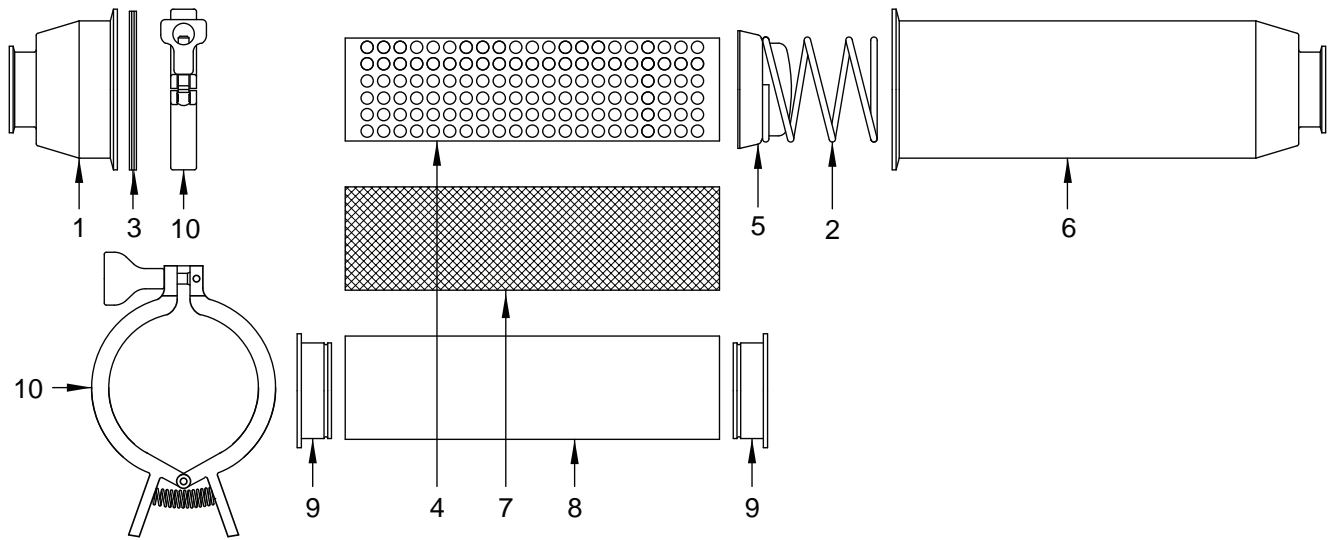

| Item # | Description                                    | Short Part #            | Long Part #            | Material             | Qty |
|--------|--|-------------------------|------------------------|----------------------|-----|
| 1      | 1" strainer outlet                             | <b>BS-01-R100</b>       | ---                    | 316L stainless steel | 1   |
|        | 1½" strainer outlet                            |                         | <b>BS-01-R150</b>      |                      |     |
|        | 2" strainer outlet                             |                         | <b>BS-01-R200</b>      |                      |     |
|        | 2½" strainer outlet                            | <b>BS-01-R250</b>       | ---                    |                      |     |
|        | 3" strainer outlet                             |                         | <b>BS-01-R300</b>      |                      |     |
| 2      | 1" - 2" strainer spring                        |                         | <b>BS-02-R100-200</b>  | 316L stainless steel | 1   |
|        | 2½" - 3" strainer spring                       |                         | <b>BS-02-R250-300</b>  |                      |     |
| 3      | 1" - 2" (4") clamp gasket                      |                         | <b>40MP-U400</b>       | Buna                 | 1   |
|        | 2½" - 3" (4") schedule 5 clamp gasket          |                         | <b>40MPV-U400</b>      |                      |     |
| 4      | 1" - 2" back-up tube with 1/8" perforations    | <b>BS-1418-R100200</b>  | <b>BS-2418-R100200</b> | 316L stainless steel | 1   |
|        | 2½" - 3" back-up tube with 1/8" perforations   | <b>BS-1418-R250300</b>  | <b>BS-2418-R250300</b> |                      |     |
|        | 1" - 2" back-up tube with 1/4" perforations    | <b>BS-1425-R100200</b>  | <b>BS-2425-R100200</b> |                      |     |
|        | 2½" - 3" back-up tube with 1/4" perforations   | <b>BS-1425-R250300</b>  | <b>BS-2425-R250300</b> |                      |     |
| 5      | 1" - 2" strainer cap                           |                         | <b>BS-05-R100-200</b>  | 316L stainless steel | 1   |
|        | 2½" - 3" strainer cap                          |                         | <b>BS-05-R250-300</b>  |                      |     |
| 6      | 1" strainer inlet                              | <b>BS-16-R100</b>       | ---                    | 316L stainless steel | 1   |
|        | 1½" strainer inlet                             | <b>BS-16-R150</b>       | <b>BS-26-R150</b>      |                      |     |
|        | 2" strainer inlet                              | <b>BS-16-R200</b>       | <b>BS-26-R200</b>      |                      |     |
|        | 2½" strainer inlet                             | <b>BS-16-R250</b>       | ---                    |                      |     |
|        | 3" strainer inlet                              | <b>BS-16-R300</b>       | <b>BS-26-R300</b>      |                      |     |
| 7      | 1" - 3" various mesh over screens (short/long) | part number on page 498 |                        | 316 stainless steel  | 1   |
| 8      | 1" - 3" various filter bag (short/long)        | part number on page 498 |                        | various              | 1   |
| 9      | 1" - 2" retaining ring used with filter bags   |                         | <b>BS-09-U100-200</b>  | Buna                 | 2   |
|        | 2½" - 3" retaining ring used with filter bags  |                         | <b>BS-09-U250-300</b>  |                      |     |
| 10     | 1" - 2" (4") squeeze clamp                     |                         | <b>13MHHM-Q400</b>     | 304 stainless steel  | 1   |
|        | 2½" - 3" (4") schedule 5 squeeze clamp         |                         | <b>13MHHV-Q400</b>     |                      |     |

N